

Mark	ECN NO.	DESCRIPTION	DESIGN	Date:

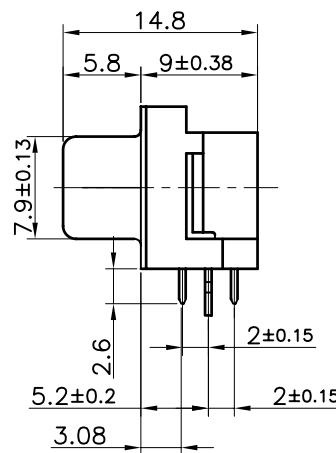

NOTES:

- *HOUSING:PBT+30%G/F
- *CONTACT:BRASS
- *SHELL: SPCC T=0.3
- *SHELL PLATING: NICKLE
- *.ELECTRIC CHARACTERISTICS:
 CONTACT CURRENT RATING: 3.0A MAX.;
 CONTACT VOLTAGE RATING:100V DC;
 CONTACT RESISTANCE: 30mΩ MAX.;
 DIELECTRIC WITHSTANDING VOLTAGE:500V AC;
 INSULATION RESISTANCE: 1000 MΩ MIN.AT DC 500V.
- *.MECHANICAL CHARACTERISTICS:
 DURABILITY: 1000 CYCLES.
 INSERTION AND EXTRACTION FORCE:
 INSERTION FORCE: 50N MAX.
 EXTRACTION FORCE: 15N MIN.
- *.ENVIRONMENT CHARACTERISTICS:
 OPERATING TEMPERATURE: -25℃~+70℃
 HUMIDITY:45-85% RH.

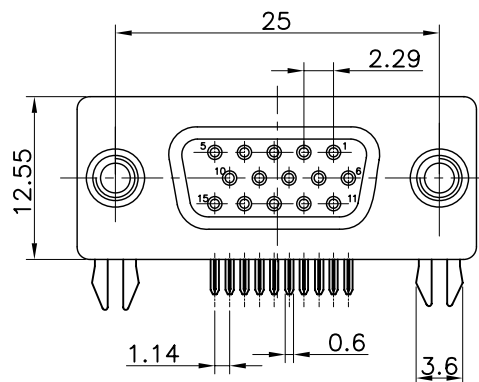
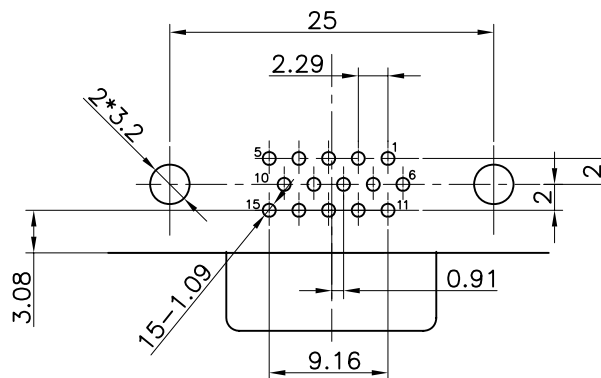
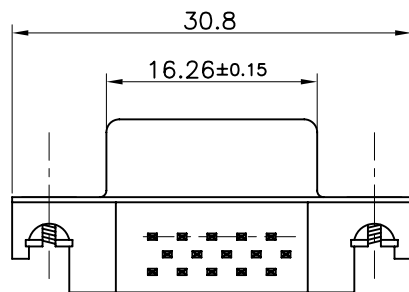

PCB Holes Diagram Top View

Tolerance X.X ±0.30 X.XX ±0.25 X.XXX ±0.15 Angle ±2.0°	Model Name: HDR 15母3.08耦合简易 (半简易全锡) 蓝胶 鱼叉改短为3.6MM 端子脚长2.6MM				Drawing: ZengL	
	Model No: WLHD-015A				Checked: Lijian	
	UNIT:	SCALE:	REVISION:	SHEET	Approved: WEI JI YANG	
	mm	FULL	A1	1/1	Date: 2011.08.29	
		WLCO ® 深圳市兴万联电子有限公司 SHENZHEN XINGWANLIAN TECHNOLOGY CO.,LTD			DWG NO.	
					FILE: C	