

RoHS

Mark	ECN NO.	DESCRIPTION	DESIGN	Date:
A	—	New	—	—

NOTES:

- 1.MATERIAL:  
MOLDING: LCP UL94 V-0  
CONTACT: COPPER ALLOY.  
GOLD PLATED ON CONTACT AREA, 100u"  
Min TIN (LEAD FREE) ON SOLDER AREA,  
SHELL: SUS304-H, T=0.30±0.03mm  
50u" NICKEL PLATING OVER ALL.  
SHILD: SUS304-H, T=0.12±0.03mm
- 2.MECHANICAL:  
INSERTION: 5~20N.  
EXTRACTION: 8~20N.  
DURABILITY: 10000 CYCLES
- 3.ELECTRICAL:  
CURRENT: 5A MIN FOR VBUS;  
0.25A MIN FOR OTHER.  
VOLTAGE: 5VAC MAX  
WITHSTANDING VOLTAGE: 100V AC.  
CONTACT RESISTANCE: 40mΩ MAX.  
INSULATION RESISTANCE: 100MΩ MIN.
- 4.ENVIRONMENTAL  
TEMPERATURE RANGE -55°C ~ +85°C

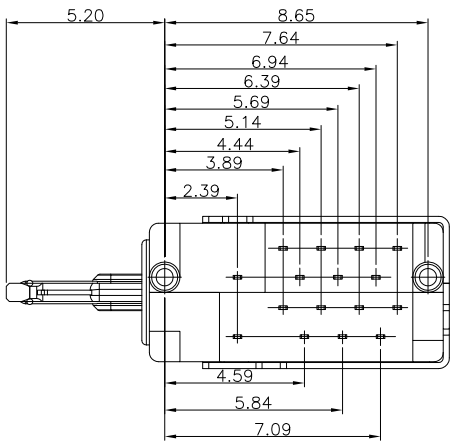
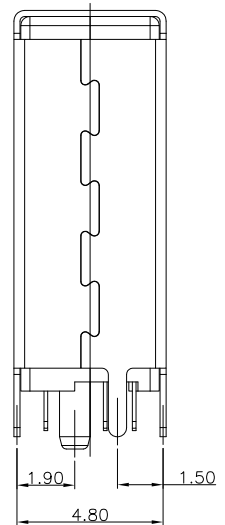
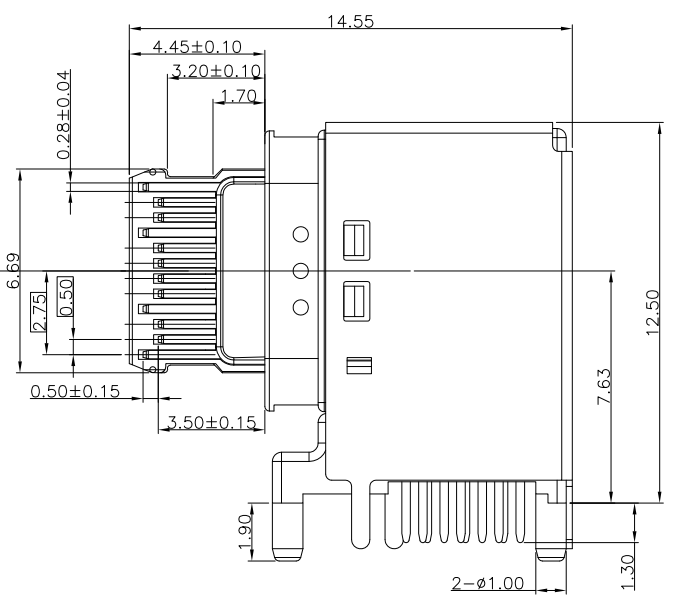
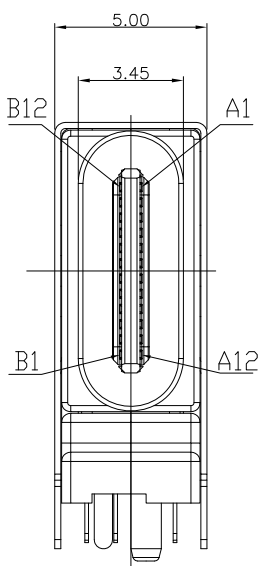
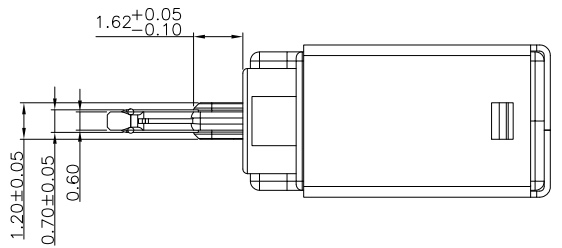

Tolerance X.X ±0.30 X.XX ±0.25 X.XXX ±0.15 Angle ±2.0°	Model Name: USB 3.1 C TYPE FEMALE 侧插 TYPE			Drawing: PYP
	Model No:			Checked: —
UNIT: mm	SCALE:	REVISION:	SHEET	Approved: Lijan
	Full	A	1/2	Date: 2015.09.22
	深圳市永利同创精密电子有限公司 SHENZHEN YLTC TECHNOLOGY CO.,LTD			DWG NO.
				FILE: C

RoHS

Mark	ECN NO.	DESCRIPTION	DESIGN	Date:
A	—	New	—	—

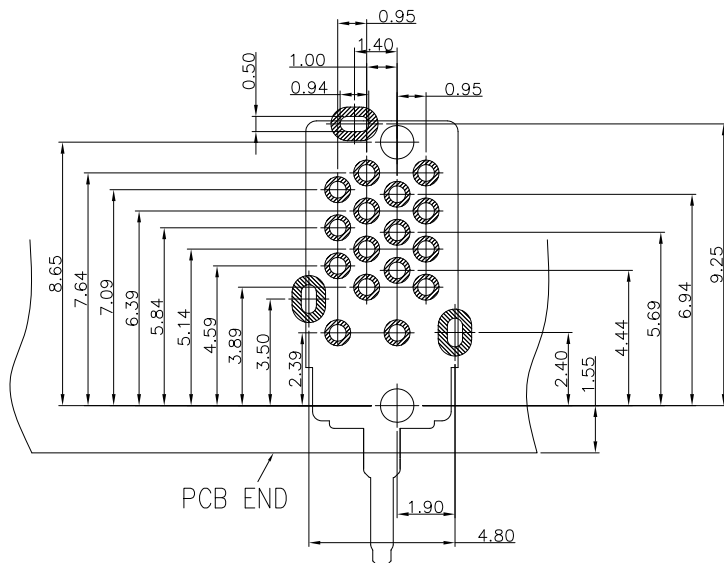
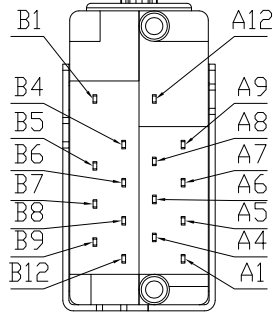
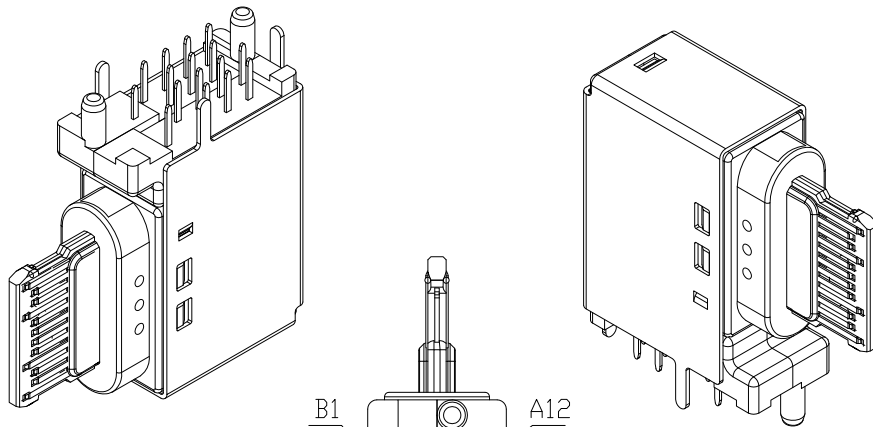

RECOMMEND P.C.B LAYOUT (THICKNESS=0.1mm)  
(COMPONENT SIDE) TOLERANCE±0.02

USB TYPE-C FULL-FEATURED RECEPTACLE INTERFACE PIN ASSIGNMENTS

PIN	Signal Name	Description	PIN	Signal Name	Description
A1	GND	Ground return	B12	GND	Ground return
A2					
A3					
A4	Vbus	Bus Power	B9	VBUS	Bus Power
A5	CC1	Configuration Channel	B8	SBU2	Sideband Use (SBU)
A6	Dp1	Positive half of the USB 2.0 differential pair-Position 1	B7	Dn2	Negative half of the USB 2.0 differential pair-Position 2
A7	Dn1	Negative half of the USB 2.0 differential pair-Position 1	B6	Dp2	Positive half of the USB 2.0 differential pair-Position 2
A8	SBU1	Sideband Use (SBU)	B5	CC2	Configuraation Channel
A9	VBUS	Bus Power	B4	VBUS	Bus Power
A10			B3		
A11			B2		
A12	GND	Ground return	B1	GND	Ground return

Tolerance X.X ±0.30 X.XX ±0.25 X.XXX ±0.15 Angle ±2.0°	Model Name: USB 3.1 C TYPE FEMALE 侧插 TYPE				Drawing: PYP
	Model No:				Checked: —
	UNIT:	SCALE:	REVISION:	SHEET	Approved: Lijan
	mm	Full	A	2/2	Date: 2015.09.22
	YLTC 深圳市永利同创精密电子有限公司 SHENZHEN YLTC TECHNOLOGY CO.,LTD				DWG NO.
					FILE: C